

SWIFTLINER[™]

NZ's smartest
pre-finished
wall lining.

 **Compac
Panels**[™]

Surfaces creating inspiration.

WHY SWIFTLINER™ ?

- **Quick and easy to install;** 600mm panels make it easy for one person to handle.
- **Hidden fixings;** panels connected with a tongue and groove joining system.
- **Pre-finished;** no plastering and painting required, reduces number of subtrades.
- **Easy to clean;** durable laminate offers and moisture and chemical resistance.
- **Anti-meth contamination;** melamine impregnated surface has excellent chemical resistance.
- **Designer look;** there is a range of 11 stocked colours available.
- **No special framing needed;** sheets don't require joining on a vertical stud.
- **Fits with standard door / window reveals and jams;** panels are 12mm thick the same as plasterboard.
- **Environmentally responsible;** made of NZ made FSC HMR MDF.
- **Great screw holding;** pictures and cabinetry etc can be mounted anywhere in the wall with no specialist fixings.
- **Repairable;** panels can be easily cut down the middle and replaced if needed.

SWIFTLINER™ HOW IT WORKS

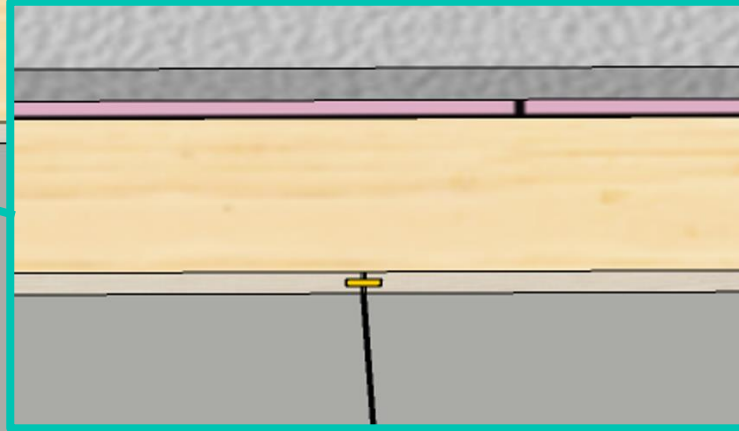
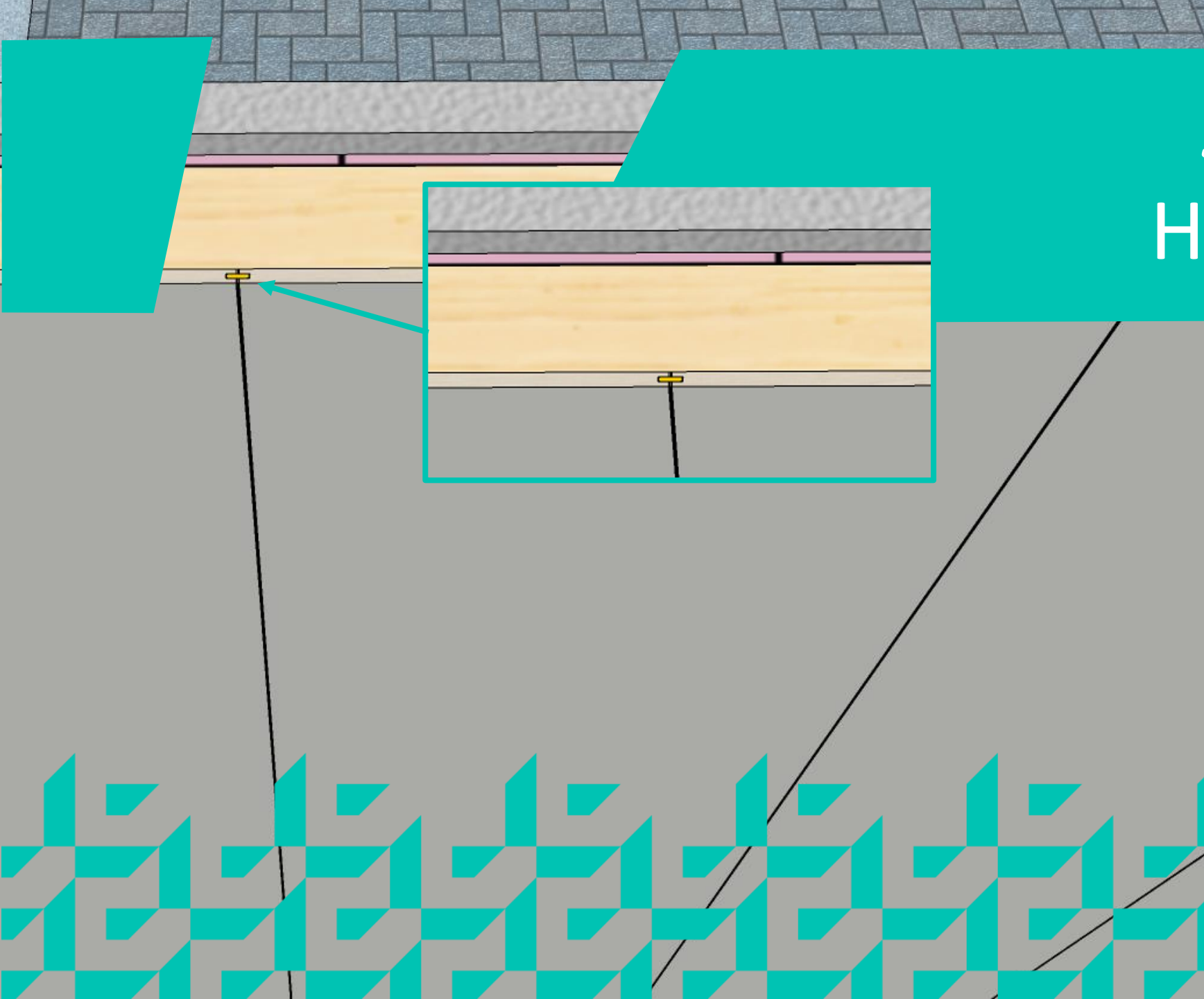

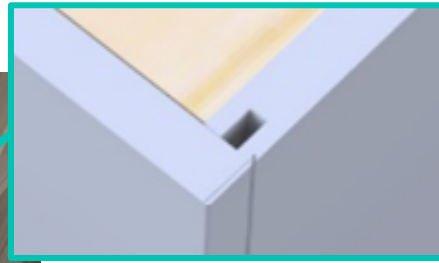
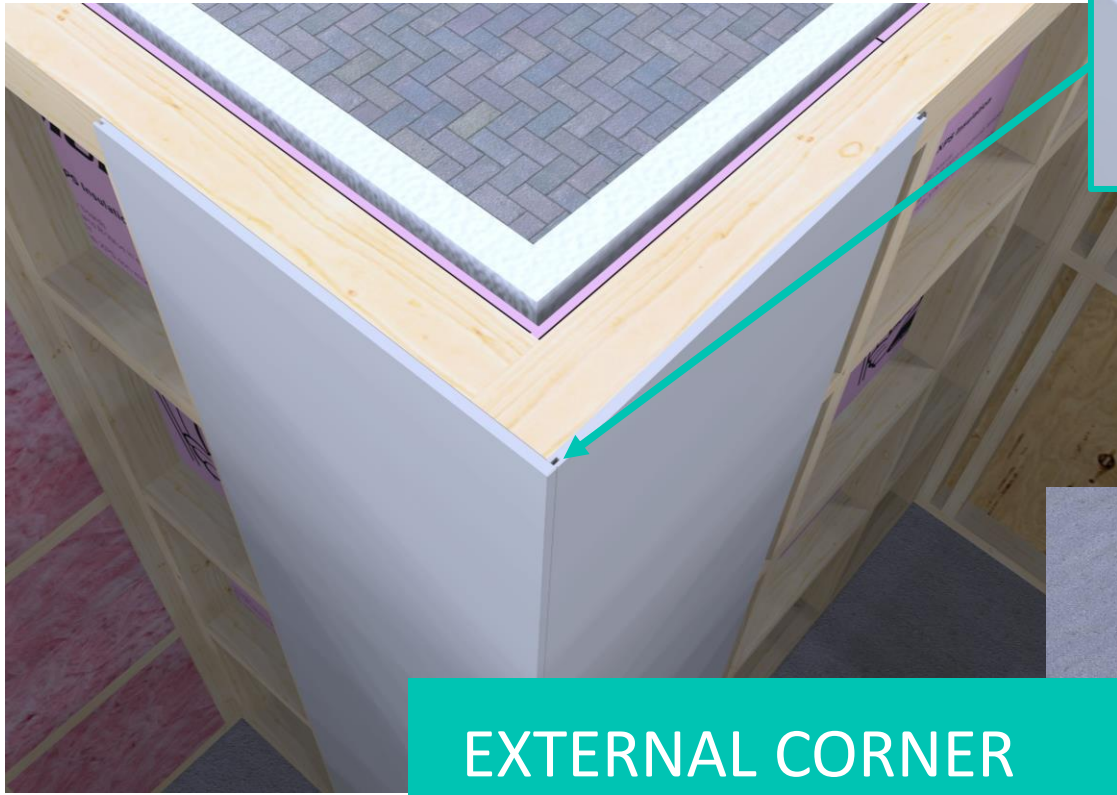

EXTERNAL CORNER

Starting from one corner of the room – work from one panel to the next. Using the specified construction adhesive.

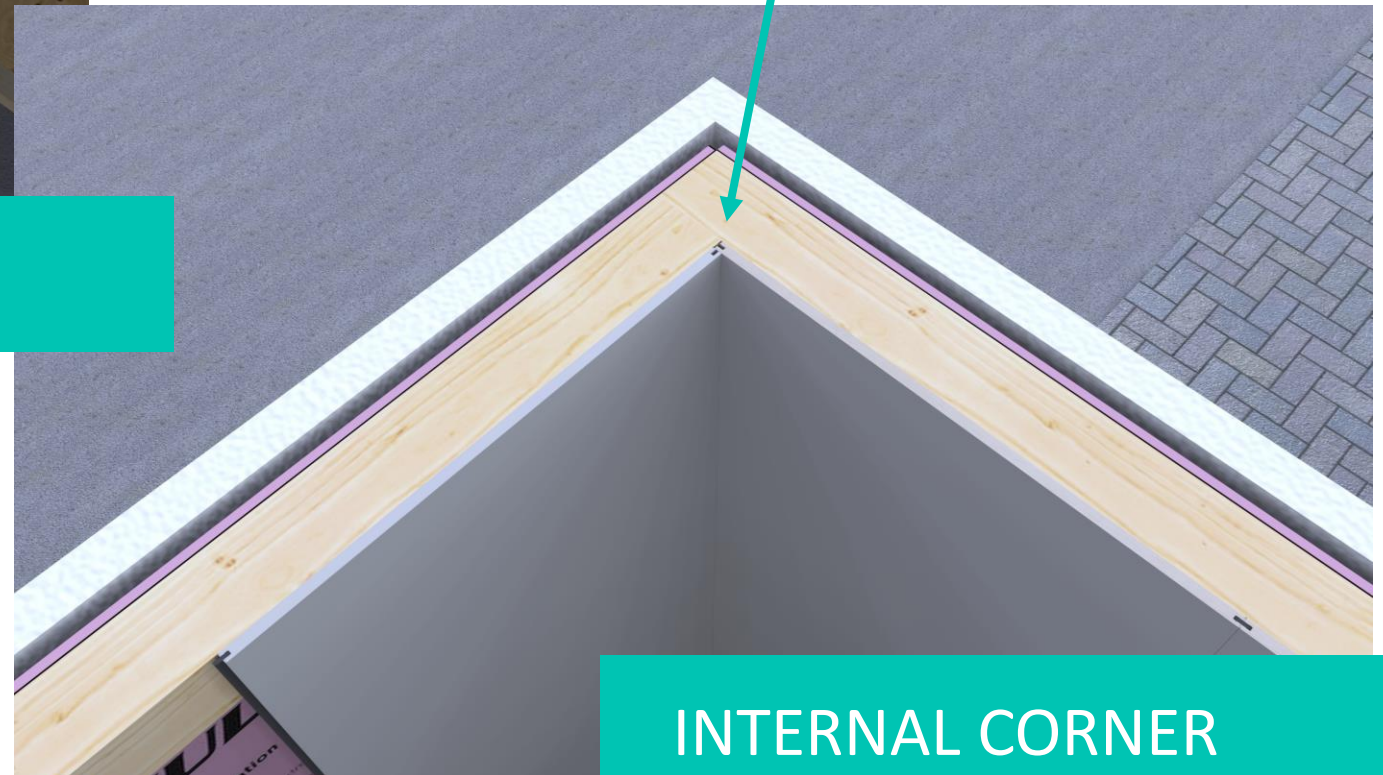

INTERNAL CORNER



INSTALLATION METHOD

Fix 5+ nails to top and bottom plate.

Nails on 45° angle into nogs.

Apply *Liquid Nails* adhesive at 300mm spacing along framing.

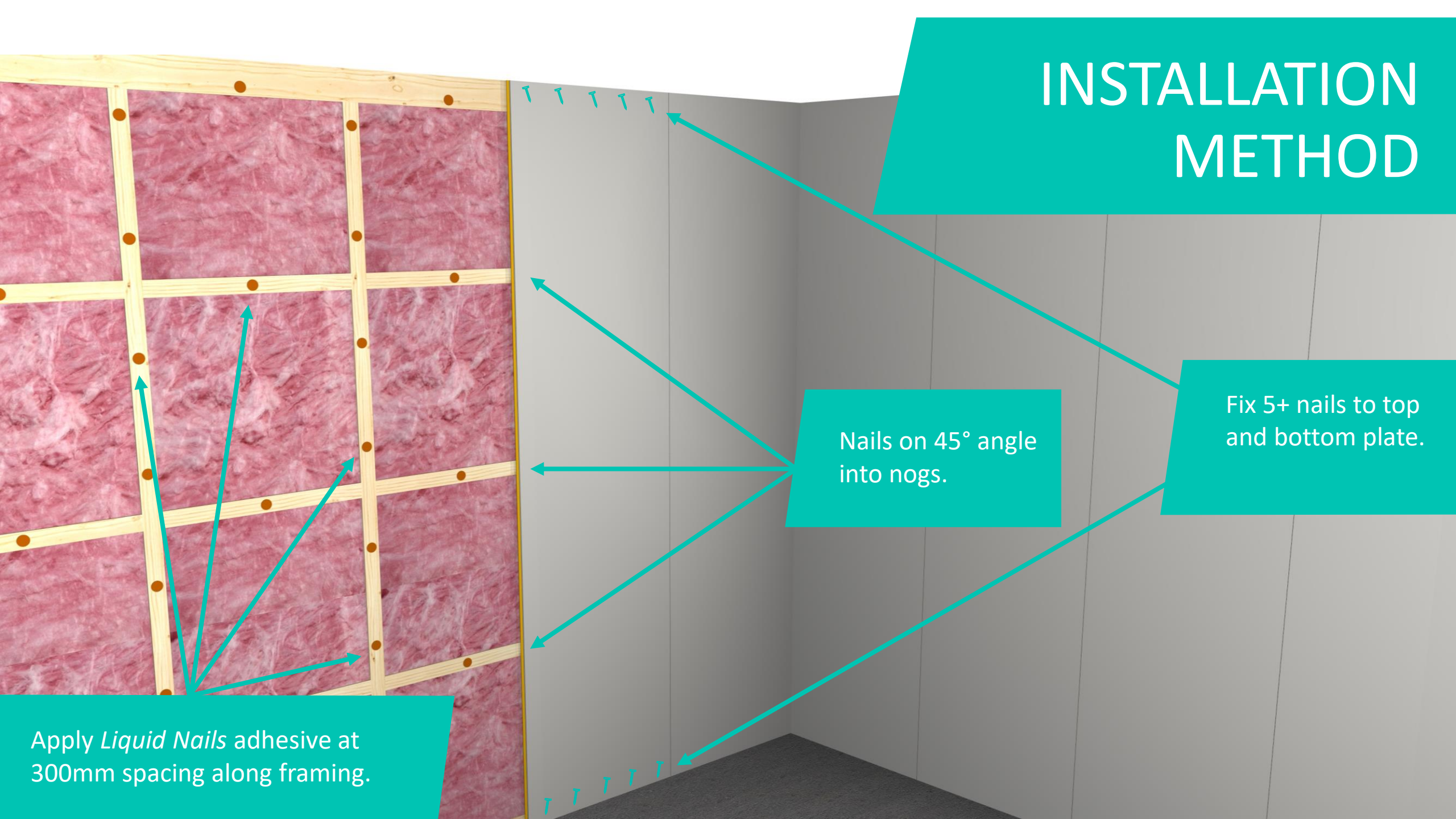



Aurora Oak



Black Stipple



Black-White



Mid Elm



Dark Elm



White



Nappa Grey



Valentina Teak



White Elm



Sinatra Oak



Coastal Elm

STOCKED COLOURS

With access to
any specific
colour on
request



SWIFTLINER™

LAYERS & MATERIALS

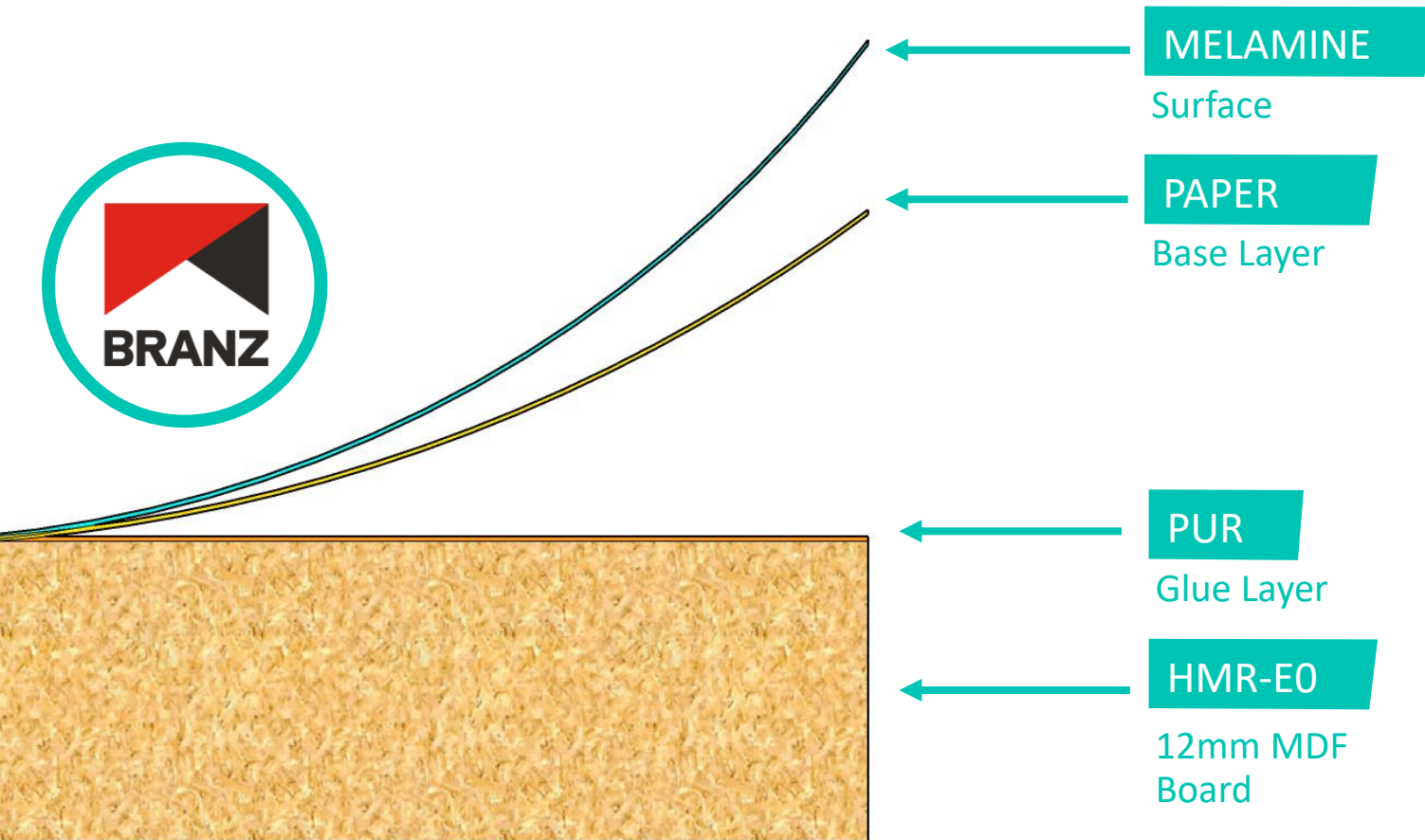

MELAMINE
Surface

PAPER
Base Layer

PUR
Glue Layer

HMR-EO
12mm MDF
Board

Laminate

CPL (Continuous Pressing Laminate) laminate is a 0.2mm thick scratch and chemical resistant surface made of two main parts, a kraft paper base, and melamine resin coating.

The kraft paper used is a FSC certified product that gives the laminate a stable base layer. This base layer is what the print layer is applied to giving the laminate its desired pattern and color.

To ensure durability and give the laminate texture the printed paper is impregnated with melamine resin and UV treated. This impregnated surface is built up through multiple layers and preserves the beauty of the decor from wear and tear for a long time.

Glue

The glue line used is a hot melt PUR (Polyurethane Reactive) adhesive which has a highly flexible and strong adhesion, and forms very strong bond after the curing process is completed.

PUR is a solvent-free adhesive and long drying tunnel is unnecessary making a truly environment-friendly, and non-toxic adhesive.

Board

The 12mm thick HMR (highly moisture resistant) E0 MDF (medium density fiberboard) board used is New Zealand made and both a sustainable and extremely durable substrate. This board is made using NZ grown Pine and is E0 with formaldehyde-emitting levels of less than 0.5 mg/L making it safe for your home. The moisture resistance of this board makes it suitable for use in damp and humid conditions. This MDF also has excellent dimensional stability and a high impact resistant.

LIMITATIONS AND WHERE NOT TO USE

- Interior use only
- Not to be used as a wet area wall lining
- Not to be used as a structured bracing element
- Not to be used as a splash back or heat shield.
- Building fire codes need to be checked to ensure the correct Group rating required.

MAINTENANCE AND DISPOSAL

Cleaning Method

For cleaning we recommend a standard household surface cleaning spray and a wipe with a rag.

Repairing Method

To repair minor damage on panel such as scratches in the laminate we recommend using wax filler such as Briwax.

Disposal Method

To remove panels simply use a Pry Bar or unscrew if screws are used instead of nails. Panels can then be then put through a woodchipper, and the fine wood chips composted by mixing with a high nitrogen material such as grass trimmings or food waste to speed up the composting process. Alternatively waste panels can be reused in other applications such as cabinetry or packaging

Steps to replacing a panel:

1. Run a circular saw set to 11mm deep up the center of the panel.
2. lever out using a Pry Bar, then
3. Replace the panel using construction adhesive and nails at the top and bottom of the panel.



PROJECT EXAMPLES

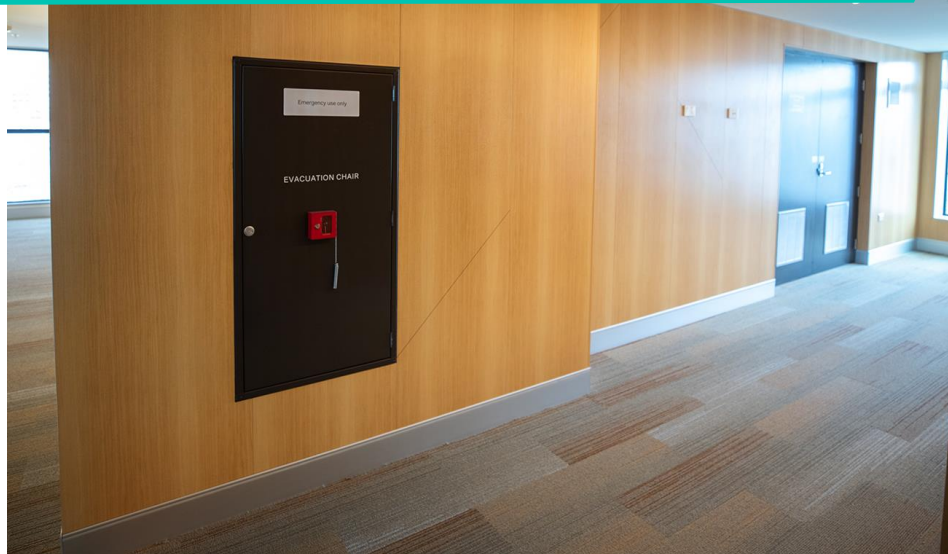

SUSTAINABILITY

Compac Panels products are manufactured in Dargaville using wood sourced from FSC-certified, sustainably harvested, New Zealand radiata pine forests. The fast-growing pine produces wood with long, strong fibers which, when processed, gives excellent screw-holding stability. This avoids warping and extends the useful life of your final products.

New Zealand-made, the quality MDF panels are manufactured from wood sourced from FSC-certified, sustainably harvested, New Zealand radiata pine forests. These are finished with durable, eco-friendly, European laminates.

All products are made to last, reduce waste, and be gentler on our people and planet. No rainforest or native forest products, plastics, harsh chemicals, or toxins are used in any phase of the process.

The state-of-the-art, energy-efficient factory runs 100% on electricity generated from New Zealand's mostly (82%) renewable energy grid.



Forest
Sustainability
Council Certified



New Zealand
Environmental
Choice



TELARC
ISO 14001
Standard

SUPPLIER CERTIFICATION